



SERIE 023DP

PNEUMATIC COUPLINGS PNEUMATISCHE KUPPLUNGEN



Temperature Range Temperaturbereich
-20°C +100°C [-4°F +212°F]

Working Pressure - Betriebsdruck
0 - 30 bar (0 - 435 PSI)

Flow capacity - Nennweite
NW - 5.5

Material - Material

Coupler body -
Kupplungsgrundkörper :Steel & Zinc Plated -
Stahl Verzinkt

Back Part -
Hinterteil :Steel Zinc Plated -
Stahl Verzinkt

Valve - Ventil :Brass - Messing
Springs & Ring-
Federn & Ring :Stainless Steel -
Edelstahl

Seals - Dichtungen :Nitrile seal NBR (Ni) -
Nitrilgummi
Dichtung NBR (Ni)

Plug - Nippel :Steel Zinc Plated -
Stahl Verzinkt

**Couplers and Plugs
Kupplungen und Nippel**

**Connection
Anschlüsse**

**Order No
Bestellnr.**

SW

L

ØD

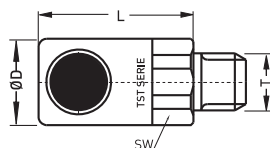

**Coupling Male Thread
Kupplung mit Aussengewinde**

1/8" BSP	023.06 EGB 10-DP	22	59	28
1/8" NPT	023.06 TGB 10-DP	22	61	28
1/4" BSP	023.06 EGB 13-DP	22	62	28
1/4" NPT	023.06 TGB 13-DP	22	64	28
3/8" BSP	023.06 EGB 17-DP	22	62	28
1/2" BSP	023.06 EGB 21-DP	22	64	28

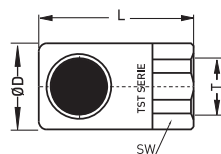

**Coupling Female Thread
Kupplung mit Innengewinde**

1/8" BSP	023.06 DGB 10-DP	22	51	28
1/8" NPT	023.06 NGB 10-DP	22	55	28
1/4" BSP	023.06 DGB 13-DP	22	51	28
1/4" NPT	023.06 NGB 13-DP	22	61.5	28
3/8" BSP	023.06 DGB 17-DP	22	50	28
1/2" BSP	023.06 DGB 21-DP	24	50	28

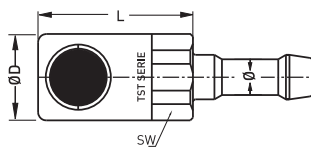

**Coupling for Rubber Hoses
Kupplung mit Schlauchanschluss**

Ø 6mm	023.06 HGB 06-DP	22	50.5	28
Ø 8mm	023.06 HGB 08-DP	22	50.5	28
Ø 10mm	023.06 HGB 10-DP	22	50.5	28
Ø 13mm	023.06 HGB 13-DP	22	50.5	28

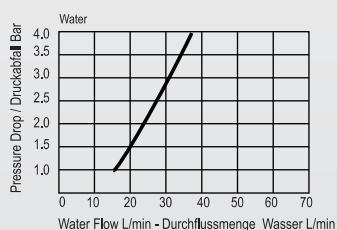
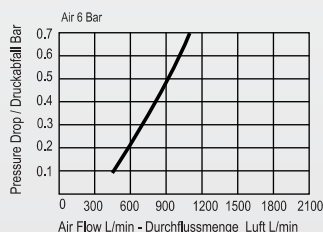

PNEUMATIC COUPLINGS
PNEUMATISCHE KUPPLUNGEN

SERIE 023DP



Couplers and Plugs
Kupplungen und Nippel

Connection
Anschlüsse

Order No
Bestellnr.

SW

L

ØD

Temperature Range Temperaturbereich
-20°C +100°C [-4°F +212°F]

Working Pressure - Betriebsdruck
0 - 30 bar (0 - 435 PSI)

Flow capacity - Nennweite
NW - 5.5

Material - Material

Coupler body -
Kupplungsgrundkörper :Steel & Zinc Plated -
Stahl Verzinkt

Back Part -
Hinterteil :Steel Zinc Plated -
Stahl Verzinkt

Valve - Ventil :Brass - Messing

Springs & Ring-
Federn & Ring :Stainless Steel -
Edelstahl

Seals - Dichtungen :Nitrile seal NBR (Ni) -
Nitrilgummi
Dichtung NBR (Ni)

Plug - Nippel :Steel Zinc Plated -
Stahl Verzinkt

023 Plugs in common with
023 DP Serie
023 Stecker gemeinsam mit 023 DP Serie

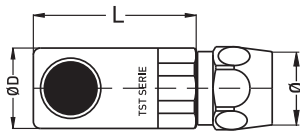

Coupling for Rubber Tube
Kupplung für Kunststoffschlauch

Ø 6.5x10mm	023.06 PGB 06	22	50.5	28
Ø 8x12mm	023.06 PGB 08	22	50.5	28
Ø 9x13mm	023.06 PGB 09	22	50.5	28

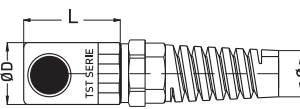

Coupling for Plastic Tube With Guard
Kupplungen mit Knickschutzfeder aus
Polyamid

Ø 6.5x10mm	023.06 YGB 06	22	50.5	28
Ø 8x12mm	023.06 YGB 08	22	50.5	28
Ø 9x13mm	023.06 YGB 09	22	50.5	28

