

**PNEUMATIC COUPLINGS**  
PNEUMATISCHE KUPPLUNGEN

**SERIE 014**



**Couplers and Plugs**  
Kupplungen und Nippel

Connection Anschlüsse | Order No Bestellnr. | SW | L | ØD

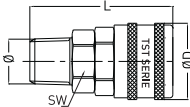

Male Thread Coupling  
Kupplung mit Aussengewinde

BSPT 1/4"	014 RG 13	19	44	25
BSPT 3/8"	014 RG 17	19	44	25
BSPT 1/2"	014 RG 21	22	47	25

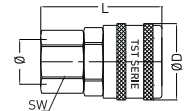

Female Thread Coupling  
Kupplung mit Innengewinde

BSP 1/4"	014 DG 13	19	42	25
BSP 3/8"	014 DG 17	19	42	25
BSP 1/2"	014 DG 21	24	45	25

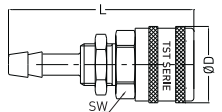

Standard Hose Barb Coupling  
Kupplung mit Schlauchtülle

6 mm - 1/4"	014 HG 06	19	55	25
8 mm - 5/16"	014 HG 08	19	55	25
9 mm - 5/14"	014 HG 09	19	55	25
10 mm - 3/8"	014 HG 10	19	55	25
13 mm - 1/2"	014 HG 13	19	55	25

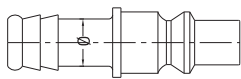

Standard Hose Barb Plug  
Nippel mit Schlauchtülle

6 mm - 1/4"	014 HU 06		46	
8 mm - 5/16"	014 HU 08		46	
9 mm - 5/14"	014 HU 09		46	
10 mm - 3/8"	014 HU 10		46	
13 mm - 1/2"	014 HU 13		46	

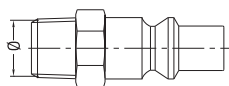

Male Thread Plug  
Nippel mit Aussengewinde

BSPT 1/8"	014 RU 10	10	42	
BSPT 1/4"	014 RU 13	14	41	
BSPT 3/8"	014 RU 17	17	41	
BSPT 1/2"	014 RU 21	22	46	
BSP 1/8"	014 EU 10	13	33	
BSP 1/4"	014 EU 13	14	37	
BSP 3/8"	014 EU 17	17	37	
BSP 1/2"	014 EU 21	22	42	

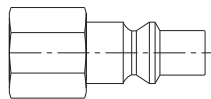

Female Thread Plug  
Nippel mit Innengewinde

BSP 1/8"	014 DU 10	14	32	
BSP 1/4"	014 DU 13	17	35	
BSP 3/8"	014 DU 17	19	35	
BSP 1/2"	014 DU 21	24	39	

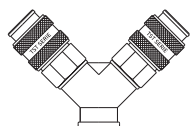

2 way couplings  
2 Wege Kupplungen

BSP 1/4"	014 2G 13			
BSP 3/8"	014 2G 17			

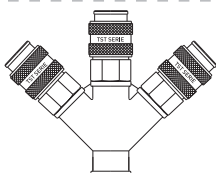

3 way couplings  
3 Wege Kupplungen

BSP 3/8"	014 3G 17			
----------	-----------	--	--	--

**Interchangeability - Kompatibilität**  
TST 022, RECTUS 14, RECTUS 22, ARO 210, PARKER 50, CEJN 300, ORION 44150, JWJ 522, JWJ 532

**Temperature Range Temperaturbereich**  
-20°C +100°C (-4°F +212°F)

**Working Pressure - Betriebsdruck**  
0 - 35 bar (0 - 508 PSI)

**Flow capacity - Nennweite**  
NW - 5

**Option - Optionen**  
Chrome plated - K-verchromt  
Nickel plated - N-vernickelt  
Viton Seal - V-Viton Dichtung  
NPTF thread - T-NPTF-Gewinde  
Brass Available

For optional orders please add the symbol of your option end of the order no.  
Bei Optionsbestellungen Kennbuchstabe bitte hinzufügen (Beispiel: 014 EG 13-K-V)

**Material - Material**

- Coupler Body- Kupplungsgrundkörper : Brass Nickel Plated - Messing Vernickelt
- Sleeve - Hülse : Brass Nickel Plated - Messing Vernickelt
- Valve - Ventil : Brass - Messing - Federn
- Spring - Federn : Stainless Steel - Edelstahl
- Locking O-Ring- Sprengring : Stainless Steel - Edelstahl
- Pins - Stifte : Stainless Steel - Edelstahl
- Seals - Dichtungen : Nitrile (Ni) - NBR (Ni)
- Plug - Nippel : Steel - Stahl

