



SERIE 071 ■

HYDRAULIC COUPLINGS
HYDRAULIK KUPPLUNGEN



- Interchangeability - Kompatibilität**
TST DESIGN
- Temperature Range - Temperaturbereich**
-20°C +100°C (-4°F +212°F)
- Working Pressure - Betriebsdruck**
0 - 35 bar (0 - 508 PSI)
- Flow capacity - Nennweite**
NW - 19

- Options - Optionen**
- F - Straight through flow - ungehinderter Durchfluss
- K - Chrome plated - verchromt
- S - Stainless Steel - Edelstahl
- V - Viton Seal - Viton Dichtung

For optional orders please add the symbol of your option end of the order no.
Bei Optionsbestellungen Kennbuchstabe bitte hinzufügen (Beispiel: 071 EG 13-K-V)

Material - Material

- Coupler Body - Kupplungsgrundkörper : Brass - Messing
- Sleeve - Hülse : Brass - Messing
- Valve - Ventil : Brass - Messing
- Springs - Federn : Stainless Steel - Edelstahl
- Locking O-Ring - Sprengring : Stainless Steel - Edelstahl
- Balls - Kugeln : Stainless Steel - Edelstahl
- Seals - Dichtungen : Buna - N - Buna N
- Plug - Nippel : Brass - Messing

According to the new coding for full flow products "F" has been added on the New Code: 071 EGF 17 - Old Code : 071 EG 17
Nach unserem neuen System, wird für ein Artikel mit freiem Durchfluss ein "F" hinzugefügt
Neue Art.nummer: 071 EGF 17 - Alte Art.nummer: 071 EG 17

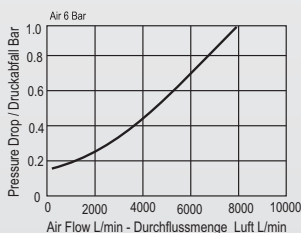
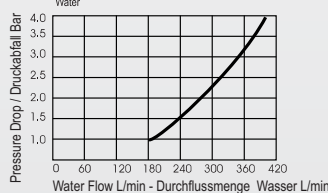
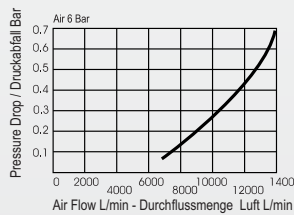

Couplers and Plugs
Kupplungen und Nippel

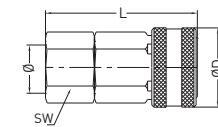
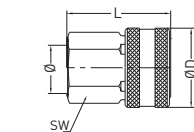

Male Threaded Coupling
Kupplung mit Aussengewinde

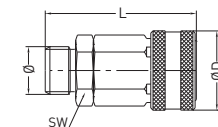

Female Thread Coupling
Kupplung mit Innengewinde

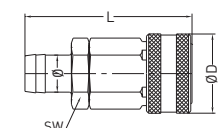

Standard Hose Barb Coupling
Kupplung mit Schlauchtülle

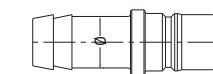

Plug With hose tail
Nippel mit Schlauchtülle

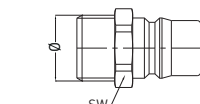

Male Thread Plug
Nippel mit Aussengewinde

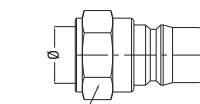

Female Thread Plug
Nippel mit Innengewinde

Connection Anschlüsse	Order No / Bestellnr.		SW	L	ØD
	Single-Shut off einseitig schlies.	Full Flow freier Durchfluss			
BSP 3/4"	071 EG 26	071 EGF 26	36	53	40
BSP 1"	071 EG 33	071 EGF 33	41	53	45

BSP 1/2"	071 EG 21	071 EGF 21	32	79	42
BSP 3/4"	071 EG 26	071 EGF 26	32	81	42
BSP 1"	071 EG 33	071 EGF 33	36	83	42
BSP 1 1/4"	071 EG 42	071 EGF 42	46	85	42

BSP 1/2"	071 DG 21	071 DGF 21	32	80	42
BSP 3/4"	071 DG 26	071 DGF 26	32	81	42
BSP 1"	071 DG 33	071 DGF 33	40	81	42
BSP 1 1/4"	071 DG 42	071 DGF 42	50	83	42

16 mm - 5/8"	071 HG 16	071 HGF 16	32	100	42
19 mm - 3/4"	071 HG 19	071 HGF 19	32	100	42
25 mm - 1"	071 HG 25	071 HGF 25	32	100	42

16 mm - 5/8"	071 HU 16				66
19 mm - 3/4"	071 HU 19				66
25 mm - 1"	071 HU 25				66

BSP 3/4"	071 EU 26	30	54
BSP 1"	071 EU 33	36	57
BSP 1 1/4"	071 EU 42	45	60

BSP 3/4"	071 DU 26	32	51
BSP 1"	071 DU 33	40	54
BSP 1 1/4"	071 DU 42	50	54