

PNEUMATIC COUPLINGS
PNEUMATISCHE KUPPLUNGEN

SERIE 121



Coupler and Plug
Kupplung und Nippel

Connection
Anschlüsse
T

Order No / Bestellnr.

Ø

L

SW

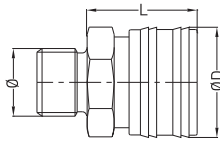

Male Thread Coupling
Without Valve
Kupplung mit Aussengewinde
ohne Ventil

BSP 3/8"	121 DGF 17	34	45	27
BSP 1/2"	121 DGF 21	34	49	27

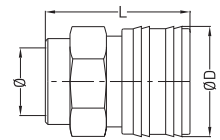

Female Thread Coupling
Without Valve
Kupplung mit Innengewinde
ohne Ventil

BSP 3/8"	121 EGF 17	34	33	27
BSP 1/2"	121 EGF 21	34	33	27
BSP 3/4"	121 EGF 26	34	33	36

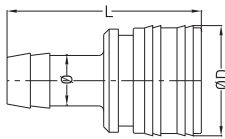

Hose Tail Coupling Without Valve
Kupplung mit Schlauchtülle
ohne Ventil

Ø 13	121 HGF 13	34	58	27
Ø 16	121 HGF 16	34	58	27
Ø 19	121 HGF 19	34	58	36

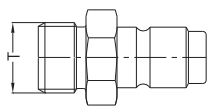

Male Threaded Plug
Nippel mit Aussengewinde

BSP 1/4"	121 EU 13		36	27
BSP 3/8"	121 EU 17		36	27
BSP 1/2"	121 EU 21		36	27
BSP 3/4"	121 EU 26		36	36

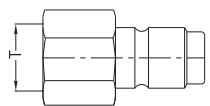

Female Threaded Plug
Nippel mit Innengewinde

BSP 1/4"	121 DU 13		47	27
BSP 3/8"	121 DU 17		47	27
BSP 1/2"	121 DU 21		47	27
BSP 3/4"	121 DU 26		47	36

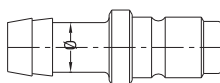

Hose Tail Plug
Nippel mit Schlauchtülle

Ø 13	121 HU 13		58	27
Ø 16	121 HU 16		58	27
Ø 19	121 HU 19		58	36

Temperature Range - Temperaturbereich
-20°C +100°C (-4°F +212°F)

Working Pressure - Betriebsdruck
Brass - Messing : 0 - 50 bar (0 - 725 PSI)
Stainless Steel - Edelstahl : 0 - 150 bar
(0 - 2175 PSI)

Flow capacity - Nennweite
NW - 12 mm (Dédi : 85 l/mm)

Standard
Stainless Steel 316 L /
Stainless Steel - Edelstahl (316 L)

Coupler Body-
Kupplungsgrundkörper : Stainless Steel -
Edelstahl (316 L)
Springs - Federn : Stainless Steel -
Edelstahl (316 L)
Balls - Kugeln : Stainless Steel -
Edelstahl (316 L)
Seals - Dichtungen : Nitrile - NBR

Options - Optionen
Material - Material
Brass Chrome Plated / Messing verchromt

Coupler Body-
Kupplungsgrundkörper : Brass Chrome Plated -
Messing verchromt
Springs - Federn : Stainless Steel -
Edelstahl (302 L)
Balls - Kugeln : Stainless Steel -
Edelstahl (316 L)
Seals - Dichtungen : Nitrile - NBR

● RUBBER COATED SOCKETS ●



Options - Optionen
KE - Safety - Sicherheitskupplung
Stainless Steel - Edelstahl
Rubber Coated Socket - Kupplung mit
Kautschukbeschichtung

For optional orders please add the symbol
of your option end of the order no.
Bei Bestellungen
Kennbuchstabe bitte hinzufügen
(Beispiel: 121 DG 21-KE)