

GZA.10

Sprue Grippers
Greifzange
Pinza Materozza
Pince de Préhension
Pinza de Presión

	A	B	C	D	Closing force (6 bar)	Sensor					
CA.GZA.10.08	64	∅ 10 G1/8	14	13	19 N		16 g				
CA.GZA.10.08.18											
CA.GZA.10.08.19			13.3								
CA.GZA.10.08.AHG	72	∅ 10									
CA.GZA.10.08.AHL											
CA.GZA.10.08.AHT											
CA.GZA.10.08.ATG											
CA.GZA.10.08.G			64.5			14					
CA.GZA.10.08.LL											
CA.GZA.10.08.M50	99								22 g		
CA.GZA.10.12	83		22.5			16.5		30 N		36 g	
CA.GZA.10.12.14	76.5	G1/8	17.5							34 g	
CA.GZA.10.12.18			19.5							50 g	
CA.GZA.10.12.19	82		22								
CA.GZA.10.12.AH	75		20				37 g				
CA.GZA.10.12.AHV											
CA.GZA.10.12.AHG	81										
CA.GZA.10.12.AHL											
CA.GZA.10.12.AHT											
CA.GZA.10.12.ATG											
CA.GZA.10.12.C				59.5			13				40 g
CA.GZA.10.12.G				83			22.5				34 g
CA.GZA.10.12.G50	120										
CA.GZA.10.12.L	76.5		21				36 g				
CA.GZA.10.12.LL	76.4		15				34 g				
CA.GZA.10.12.M	76.5		20				35 g				
CA.GZA.10.12.M50	114.5	∅ 10	19.5				43 g				
CA.GZA.10.12.MC	76.5										
CA.GZA.10.12.MF											
CA.GZA.10.12.MS	76.4			21.5			MMD.IL5AP3AVF80		44 g		
CA.GZA.10.12.MSN							MMD.IL5AN3AVF80				
CA.GZA.10.12.S	83			22			MMD.IL5AP3AVF80		50 g		
CA.GZA.10.12.SN							MMD.IL5AN3AVF80				
CA.GZA.10.12.S4	76.2			19			MMD.IL5AP3AVF80		59 g		
CA.GZA.10.12.S4N							MMD.IL5AN3AVF80				
CA.GZA.10.12.S9	83			24.5		MMD.IL5AP3AVF80	65 g				
CA.GZA.10.12.S9N								MMD.IL5AN3AVF80			
CA.GZA.10.12.SG								MMD.IL5AP3AVF80	62 g		
CA.GZA.10.12.SGN	83	23		MMD.IL5AN3AVF80							

CA.GZA.10.08.19

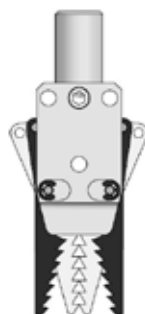

CA.GZA.10.08.G

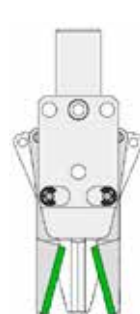

CA.GZA.10.08.LL

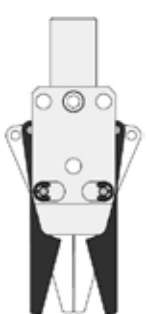

CA.GZA.10.08.AHT



CA.GZA.10.08.ATG

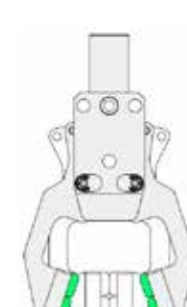

CA.GZA.10.08.AHG



CA.GZA.10.08.AHL



CA.GZA.10.08

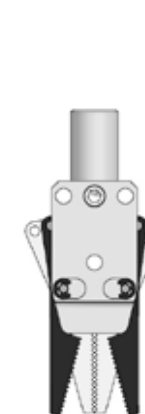

CA.GZA.10.08.18

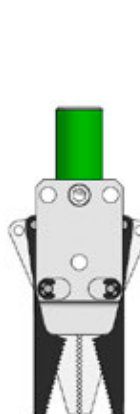

CA.GZA.10.08.M50



New

	Output	
CA.SCP.1008	PNP	65 g
CA.SCP.1012		

CA.GZA.10.12

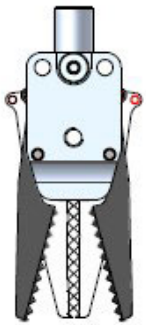

CA.GZA.10.12.AH



CA.GZA.10.12.14

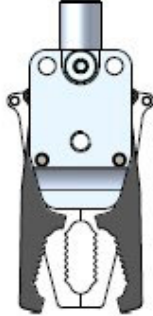

CA.GZA.10.12.18

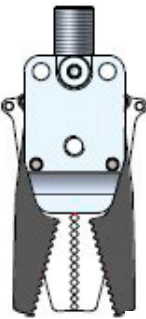

CA.GZA.10.12.M50

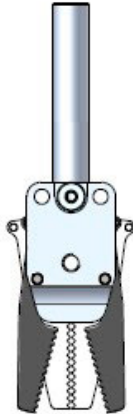

CA.GZA.10.12.19

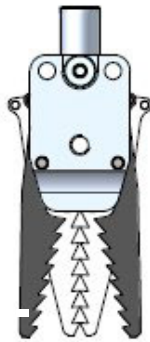

CA.GZA.10.12.C

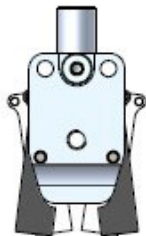

CA.GZA.10.12.G

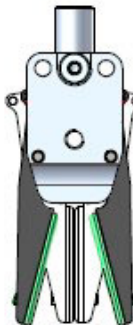

CA.GZA.10.12.L

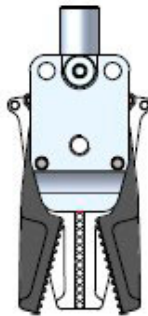

CA.GZA.10.12.M

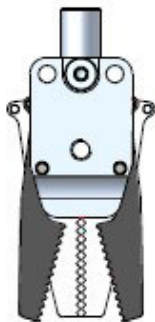

CA.GZA.10.12.LL



CA.GZA.10.12.MC

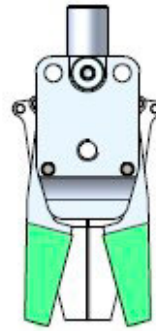

CA.GZA.10.12.MS/MSN

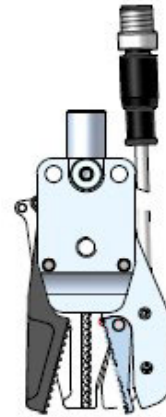

CA.GZA.10.12.G50



CA.GZA.10.12.SG/SGN

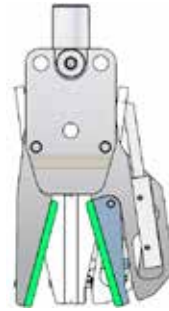

CA.GZA.10.12.S/SN

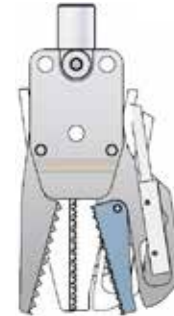

CA.GZA.10.12.S9/S9N

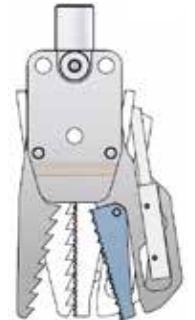

CA.GZA.10.12.S4/S4N

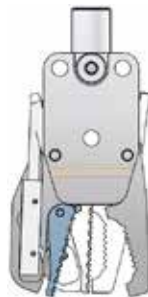

CA.GZA.10.12.L90

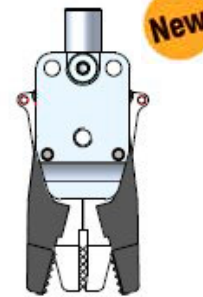

CA.GZA.10.12.AHG

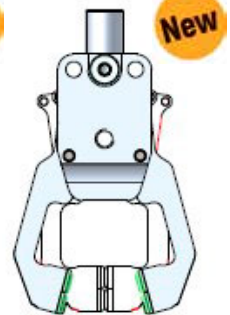

CA.GZA.10.12.AHT

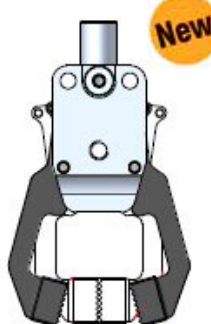

CA.GZA.10.12.AHL

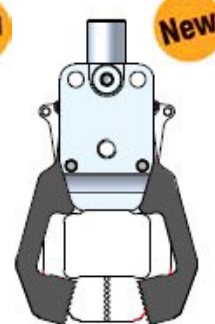

CA.GZA.10.12.ATG

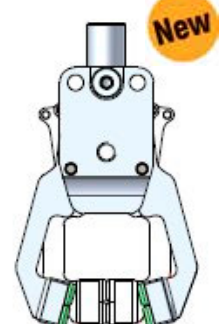



PAC Magnetic

Selfcentering Sprue Grippers
Selbstzentrierende Anguss-Greifzangen
Pinza Materozza Autocentrante
Pinces Pneumatique Angulaire Auto Centreuse
Pinza de Presión Autocentrante

	Sensor		
CA.PAC20.169			153 g
CA.PAC20.16A			95 g
CA.PAC20.16E			104 g
CA.PAC20.16K			135 g
CA.PAC20.16P			102 g
CA.PAC20.16R			165 g
CA.PAC20.16S	KT58PM8	PNP	157 g
CA.PAC20.16S9			187 g
CA.PAC20.16SN	KT58NM8	NPN	192 g
CA.PAC20.16S9N			187 g
CA.PAC20.16SP	KT58PM8	PNP	111 g
CA.PAC20.16SPN	KT58NM8	NPN	
CA.PAC20.16W	KT58PM8	PNP	162 g
CA.PAC20.16WN	KT58NM8	NPN	126 g

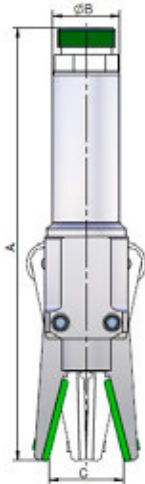

	A	B	C
CA.PAC20.16A	107		/
CA.PAC20.16E	130	Ø 20	21
CA.PAC20.16K			22
CA.PAC20.16P			22.8
CA.PAC20.16R			23
CA.PAC20.16S/SN			22.3
CA.PAC20.16SP/SPN			25
CA.PAC20.16W/WN			21.5

CA.PAC20.169 CA.PAC20.16R CA.PAC20.16P CA.PAC20.16K CA.PAC20.16E



CA.PAC20.16S9N CA.PAC20.16S CA.PAC20.16SP CA.PAC20.16W CA.PAC20.16A
CA.PAC20.16S9N CA.PAC20.16SN CA.PAC20.16SPN CA.PAC20.16WN

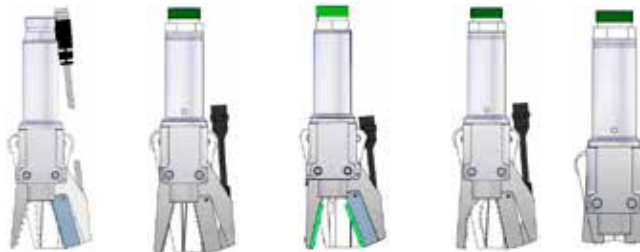

Insert
Einlage
Gommino per Pinza
Insert
Inserto para Pinza

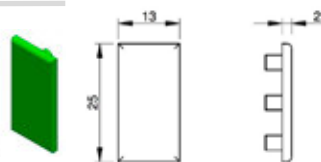

PAC.20.16P.03.V	VITON	4 g
-----------------	-------	-----

GRZ.20



Sprue Grippers
Greifzange
Pinza Materozza
Pince de Préhension
Pinza de Presión

	Sensor	Closing force (6bar)	
CA.GRZ.20.A		90 N	114 g
CA.GRZ.20.E			85 g
CA.GRZ.20.LL			85 g
CA.GRZ.20.R			121 g
CA.GRZ.20.S	GRZ.20.SC.PNP		127 g
CA.GRZ.20.SN	GRZ.20.SC.NPN		107 g
CA.GRZ.20.W	GRZ.20.SC.PNP		110 g
CA.GRZ.20.WN	GRZ.20.SC.NPN		114 g
CA.GRZ.20.WL	GRZ.20.SC.PNP		110 g
CA.GRZ.20.WLN	GRZ.20.SC.NPN		110 g

	A	B	C
CA.GRZ.20.A	100	Ø 20	15
CA.GRZ.20.E	115		22
CA.GRZ.20.LL			
CA.GRZ.20.R			
CA.GRZ.20.S/SN			
CA.GRZ.20.W/WN			
CA.GRZ.20.WL/WLN			



CA.GRZ.20.A CA.GRZ.20.E CA.GRZ.20.LL CA.GRZ.20.R



CA.GRZ.20.S/SN CA.GRZ.20.W/WN CA.GRZ.20.WL/WLN



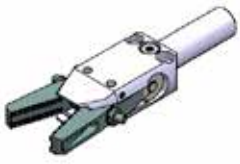

GTS.14 / GTS.20

Sprue Grippers
Greifzange
Pinza Materozza
Pinça de Préhension
Pinza de Presión

	Sensor	Closing force (6bar)	
CA.GTS.1003.1212		45 N	115 g
CA.GTS.1003.1214			110 g
CA.GTS.1003.1717			115 g
CA.GTS.1003.1919			112 g
CA.GTS.1003.2929			110 g
CA.GTS.1003.1215	GRZ.20.SC.PNP		120 g
CA.GTS.1003.125N	GRZ.20.SC.NPN		
CA.GTS.1003.1415	GRZ.20.SC.PNP		116 g
CA.GTS.1003.145N	GRZ.20.SC.NPN		
CA.GTS.1003.1915	GRZ.20.SC.PNP		96 g
CA.GTS.1003.195N	GRZ.20.SC.NPN		

	Sensor	Closing force (6bar)	
CA.GTS.1004.1212		90 N	151 g
CA.GTS.1004.1214			144 g
CA.GTS.1004.1717			151 g
CA.GTS.1004.1919			146 g
CA.GTS.1004.2929			144 g
CA.GTS.1004.1215	GRZ.20.SC.PNP		160 g
CA.GTS.1004.125N	GRZ.20.SC.NPN		
CA.GTS.1004.1415	GRZ.20.SC.PNP		120 g
CA.GTS.1004.145N	GRZ.20.SC.NPN		

	A	B	C	D
CA.GTS.1003.1212	116,5	∅ 14	18	18
CA.GTS.1003.1214			19,2	
CA.GTS.1003.1717			18,1	
CA.GTS.1003.1919			18,8	
CA.GTS.1003.1215/125N			18	
CA.GTS.1003.1415/145N			19,4	
CA.GTS.1003.1915/195N			18	
CA.GTS.1003.2929	113		18	



	A	B	C	D
CA.GTS.1004.1212	127,5	∅ 20	25	18
CA.GTS.1004.1214			23	
CA.GTS.1004.1717			24,8	
CA.GTS.1004.1919			25,5	
CA.GTS.1004.2929			23	
CA.GTS.1004.1215/125N			24	
CA.GTS.1004.1415/145N			24	

GTS.03.G18	52 g
GTS.04.G18	95 g

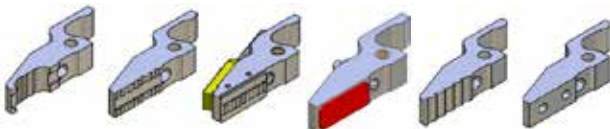

GTS.03.14	GTS.03.12	GTS.03.15/15.N	GTS.03.17	GTS.03.19	GTS.03.29
22 g	27 g	35 g	27 g	26 g	25 g
GTS.04.14	GTS.04.12	GTS.04.15/15.N	GTS.04.17	GTS.04.19	GTS.04.29
26 g	31 g	39 g	31 g	30 g	29 g

CA.GTS.1003.1212
CA.GTS.1004.1212



CA.GTS.1003.1717
CA.GTS.1004.1717



CA.GTS.1003.1214
CA.GTS.1004.1214



CA.GTS.1003.1919
CA.GTS.1004.1919



CA.GTS.1003.1215/125N
CA.GTS.1004.1215/125N



CA.GTS.1003.1415/145N
CA.GTS.1004.1415/145N



CA.GTS.1003.1915/195N



CA.GTS.1003.2929
CA.GTS.1004.2929



GRF Magnetic

Gripper Finger
Greiffinger
Dito di Presa
Doigt de Préhension à Blocage Angulaire
Dedo Pinza

Part No.	Angle	Force (N)	Weight (g)
CA.GRF.1435	35°	26 N	25 g
CA.GRF.2035		100 N	65 g
CA.GRF.3035		430 N	206 g
CA.GRF.1495	95°	19 N	25 g
CA.GRF.2095		70 N	60 g
CA.GRF.3095		300 N	193 g
CA.GRF.1490	90°	19 N	25 g
CA.GRF.2090		70 N	65 g
CA.GRF.3090		300 N	185 g
CA.GRF.1495.G	95°	19 N	28 g
CA.GRF.2095.G		70 N	75 g
CA.GRF.3095.G		300 N	235 g
CA.GRF.1495.GW	95°	19 N	25 g
CA.GRF.2095.GW		70 N	60 g
CA.GRF.3095.GW		300 N	193 g
CA.GRF.2035.WE	35°	100 N	76 g
CA.GRF.3035.WE		430 N	259 g



Stopper for Gripper
Anschlagstück
Riscontro Pinza
Butée Pince
Elemento Stop

Part No.	A	B	M*	Weight (g)
CA.ANS.14	∅ 14	20	CA.GRF.14..	17 g
CA.ANS.20	∅ 20	25	CA.GRF.20..	21 g
CA.ANS.30	∅ 30	35	CA.GRF.30..	30 g



Gripper Guide
Zentrierstück
Guida Pinza
Guide Doigt de Préhension
Elemento de Centrado

Part No.	A	B	M*	Weight (g)
CA.ZTS.14	∅ 14	24	CA.GRF.14..	15 g
CA.ZTS.20	∅ 20	30	CA.GRF.20..	20 g
CA.ZTS.30	∅ 30	45	CA.GRF.30..	60 g

Holder for Cylinder sensor
Halte für Zylindersensor
Supporto per sensore cilindrico
Support pour capteur de cylindre
Soporte para sensor de cilindro

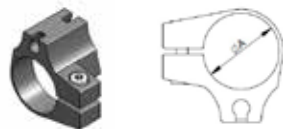

Part No.	A	M*	Sensor
CA.TIK.14007	14	CA.GRF.14..	KT38...
CA.TIK.20007	20	CA.GRF.20..	
CA.TIK.30007	30	CA.GRF.30..	



GRF.VS

Gripper Finger
Greiffinger
Dito di Presa
Doigt de Préhension à Blocage Angulaire
Dedo Pinza

Part No.	Angle	Force (N)	Weight (g)
CA.GRF.1495.VSX	95°	19 N	35 g
CA.GRF.2095.VSX		70 N	85 g
CA.GRF.3095.VSX		300 N	280 g

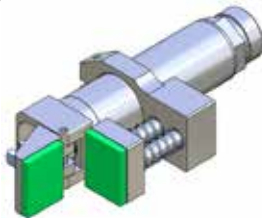

Stopper for Grippers VITON
Anschlagstück VITON
Gommino Collare per Pinza VITON
Butée Pince VITON
Elemento Stop Para Pinza VITON

Part No.	A	B	M*	Weight (g)
GRF14.95.0708	∅ 14	20	CA.GRF.14..	5 g
GRF20.95.0708	∅ 20	25	CA.GRF.20..	14 g
GRF30.95.0708	∅ 30	37	CA.GRF.30..	33 g
GRF30.95.0708.40		36		62 g

Stopper for grippers
Anschlagstück
Riscontro Pinza
Butée Pince
Elemento Stop

Part No.	A	M*	Weight (g)
GRF14.VSX	14	CA.GRF.14..	15 g
GRF20.VSX	20	CA.GRF.20..	20 g
GRF30.VSX	30	CA.GRF.30..	50 g

Insert VITON
VITON Einlage
Gommino per Pinza VITON
Insert VITON
Inserto para Pinza VITON

Part No.	A	B	M*	Weight (g)	
GRF14.95.08.V	VITON	14	10	CA.GRF.14..	1 g
GRF20.95.08.V		20	15	CA.GRF.20..	2 g
GRF30.95.08.V		30	20	CA.GRF.30..	3 g

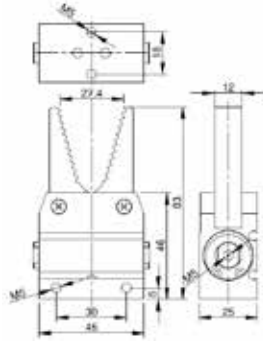

Selfcentering sprue gripper
Selbstzentrierende Anguss Greifzange
Pinza Materozza
Pince de Préhension
Pinza Pressosa

Part Number	Configuration	Weight
CA.GZA.AA24	Double effect	115 g
CA.GZA.AA24.NO		
CA.GZA.AA24.NOS2	Normally Open	151 g
CA.GZA.AA24.NOSN		
CA.GZA.AA24.NOSP		

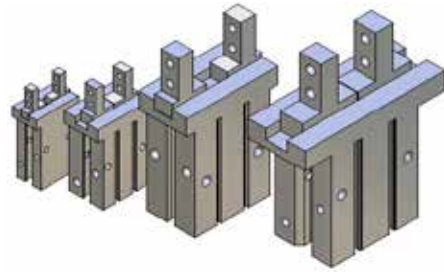

	PNP	NPN
CA.09.05.009 CA.09.05.009.NC CA.09.05.009.NO	DS1HPC08	DS1HNC8
CA.09.05.009.L	SMC.D.Y7PSAPC	SMC.D-Y59ASAPC
CA.09.05.010 CA.09.05.010.NC CA.09.05.010.NO	KT38PM8 KT38P3M KT58PM8 KT58P3M	KT38NM8 KT38N3M KT58NM8 KT58N3M
CA.09.05.010.L		
CA.09.05.011 CA.09.05.011.NC CA.09.05.011.NO		
CA.09.05.011.L		
CA.09.05.012 CA.09.05.012.NC CA.09.05.012.NO		
CA.09.05.012.L		
CA.09.05.013		
CA.09.05.014		



Pneumatic tilt
Pneumatische Kippeinheit
Ribaltatore pneumatico
Unité de basculement pneumatique
Volteador neumático

Part Number	Stroke	External Diameter	Grip force (at 6 bar)	Cycle air consumption	
CA.RBL.30	90°	Ø 30 mm	300 N	12,9 cm ³	270 g

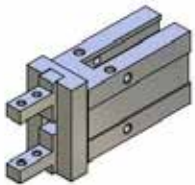

EASY GS

Parallel Gripper Easy
Parallelgreifer Easy
Pinza Parallela due Griffe Autocentranti Easy
Pince Pneumatique Parallèle double Effet Auto-Centreuse
Pinza Paralela (estándar) Easy

Part Number	Bore size	Stroke	Opening gripping force	Closing gripping force	Weight
CA.09.05.009 CA.09.05.009.NC CA.09.05.009.NO	10	4	22 N	34 N	55 g
CA.09.05.009.L		8			60 g
CA.09.05.010 CA.09.05.010.NC CA.09.05.010.NO	16	6	68 N	90 N	135 g
CA.09.05.010.L		12			
CA.09.05.011 CA.09.05.011.NC CA.09.05.011.NO	20	10	84 N	132 N	235 g
CA.09.05.011.L		18			270 g
CA.09.05.012 CA.09.05.012.NC CA.09.05.012.NO	25	14	130 N	208 N	430 g
CA.09.05.012.L		22			470 g
CA.09.05.013	32	22	316 N	386 N	715 g
CA.09.05.014	40	30	508 N	636 N	1275 g

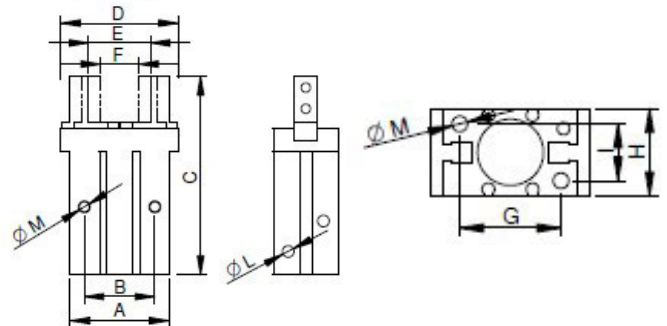

Part Number	A	B	C	D	E	F	G	H	I	L	M
CA.09.05.009 CA.09.05.009.NC CA.09.05.009.NO	23	16	57	30	16	11.5	18	16,4	12	M3	M3
CA.09.05.009.L				35	20.5						
CA.09.05.010 CA.09.05.010.NC CA.09.05.010.NO	30.5	24	67	39	21.5	14.9	22	23,6	15		M4
CA.09.05.010.L				70	47						
CA.09.05.011 CA.09.05.011.NC CA.09.05.011.NO	42	30	85	53	27.5	16.5	32	27,6	18	M5	
CA.09.05.011.L				90	62						
CA.09.05.012 CA.09.05.012.NC CA.09.05.012.NO	52	36	102	71	34	19	40	33,6	22	M6	
CA.09.05.012.L				106	75						
CA.09.05.013	60	46	113	97	47	26	46	40	26		
CA.09.05.014	72	56	139	119	61,4	30	56	48	32		M8

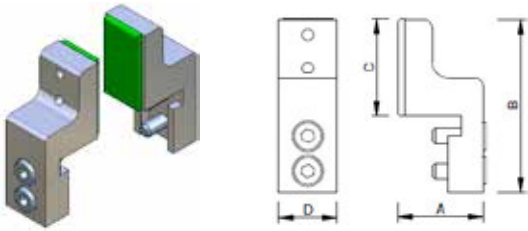

Jaws for Parallel Gripper GS (complete)
 Grundbacken für Parallelgreifer GS (komplett)
 Dita per Pinza Parallela GS (complete)
 Mâchoires pour Pince Parallèle
 Garras para el Ajuste Modular GS (completas)

	Insert	A	B	C	D	M*	
CA.KB.10	GRF14.95.08.V	15.5	27	14	10	CA.09.05.009/L	14 g
CA.KB.16	GRF20.95.08.V	18.5	35	20	15	CA.09.05.010/L	28 g
CA.KB.20	PAC.20.16P.03.V	22	44.5	25		CA.09.05.011/L	41 g
CA.KB.25		29	55	20	25	CA.09.05.012/L	73 g
CA.KB.32	GRF30.95.08.V	36	65.5	30		CA.09.05.013	166 g

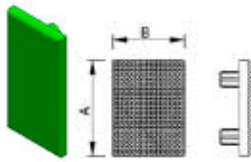

Insert VITON
 VITON Einlage
 Gommino per Pinza VITON
 Insert VITON
 Inserto para Pinza VITON

		A	B	M*	
GRF14.95.08	TPU	14	10	CA.KB.10	1 g
GRF20.95.08		20	15	CA.KB.16	2 g
PAC.20.16P.03		25	13	CA.KB.20 CA.KB.25	4 g
GRF14.95.08.V	VITON	14	10	CA.KB.10	1 g
GRF20.95.08.V		20	15	CA.KB.16	2 g
PAC.20.16P.03.V		25	13	CA.KB.20 CA.KB.25	4 g

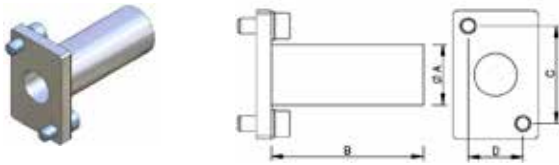

Adapter for Parallel Gripper Easy
 Adapter für Parallelgreifer Easy
 Staffa per Pinze Parallele Easy
 Support pour Fixation Pince Easy
 Estructo para Pinza Paralela Easy

	A	B	C	D	M*	
CA.APGE.10.10.30	10	30	18	12	CA.09.05.009/L	11 g
CA.APGE.16.14.40	14	40	22	15	CA.09.05.010/L	21 g
CA.APGE.20.20.50	20	50	32	18	CA.09.05.011/L	38 g
CA.APGE.25.20.50			40	22	CA.09.05.012/L	55 g
CA.APGE.32.20.50			46	26	CA.09.05.013	102 g
CA.APGE.40.20.50			56	32	CA.09.05.014	140 g

MPG

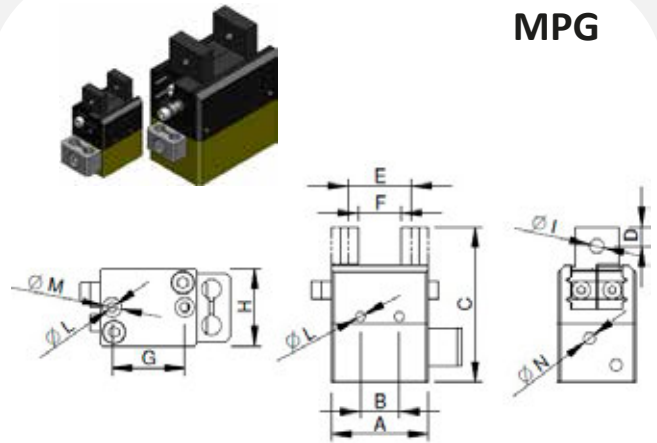

Parallel Gripper
 Parallelgreifer
 Pinza Parallela
 Pince Pneumatique Parallèle Auto-Centreuse
 Pinza Paralela Compacta

	A	B	C	D	E	F	G	H	I	L	M	N
CA.MPG.20	20	8	32	4	13	9	15	16	3	M2,5	4	M3
CA.MPG.25	26		34		17	11	20	18		M3	5	
CA.MPG.32	32	10	43	5	22	14	25	22	4	M4	6	M5
CA.MPG.40	40		51	6	28	16	32	26				
CA.MPG.50	50	40	60	7	35	18	40	30	5	M5	8	
CA.MPG.64	64	52	70	8	44	24	52	35				

	Stroke	Opening total gripping force	Closing total gripping force	
CA.MPG.20	4	24 N	28 N	40 g
CA.MPG.25	6	28 N	31 N	60 g
CA.MPG.32	8	55 N	65 N	120 g
CA.MPG.40	12	90 N	110 N	200 g
CA.MPG.50	16	155 N	175 N	350 g
CA.MPG.64	20	190 N	200 N	600 g

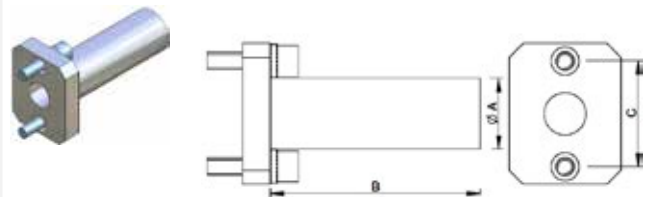

Adapter for Parallel Gripper MPG
 Adapter für Parallelgreifer MPG
 Staffa per Pinza Parallela MPG
 Support pour Fixation Pince MPG
 Estructo para Pinza Paralela MPG

	A	B	C	M*	
CA.APG.20.10.30	10	30	15	CA.MPG.20	8 g
CA.APG.25.14.40	14	40	20	CA.MPG.25	16 g
CA.APG.32.14.40			25	CA.MPG.32	23 g
CA.APG.40.14.50	20	50	30	CA.MPG.40	22 g
CA.APG.40.20.50			32		30 g
CA.APG.50.20.50	20	50	40	CA.MPG.50	48 g
CA.APG.65.20.50			52	CA.MPG.64	63 g

Firestone

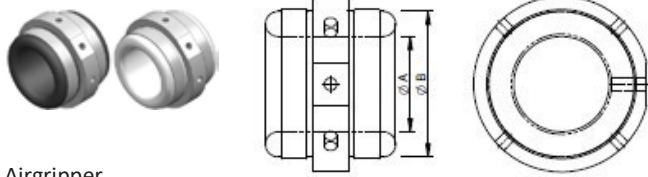

Airgripper
Pneumatische Außengreifer
Pinza ad Espansione per Esterni
Préhenseurs Extérieurs
Pinza de Expansión

	FIRESTONE	Working range	A	B	
CA.09.13.05.15 CA.09.13.05.15.S	WP1-M58-5001 WP1-M58-5005	5-15 mm	19	33	60 g
CA.09.13.10.25 CA.09.13.10.25.S	WP1-M58-5002 WP1-M58-5006	10-25 mm	27	48	145 g
CA.09.13.15.35 CA.09.13.15.35.S	WP1-M58-5003 WP1-M58-5007	15-35 mm	37	58	210 g
CA.09.13.20.45 CA.09.13.20.45.S	WP1-M58-5004 WP1-M58-5008	20-45 mm	48	69	285 g

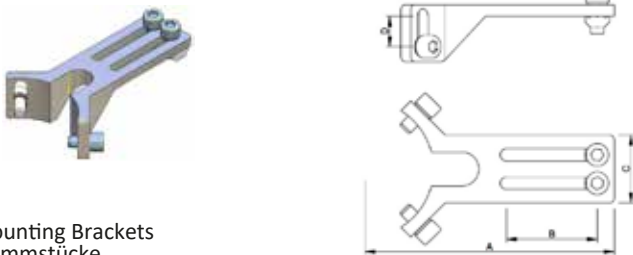

Mounting Brackets
Klemmstücke
Staffa per Pinza
Bride pour le Montage de la Pince sur Profile
Estribo para Pinza

	M* M1	A	B	C	D	
CA.09.17.0515.X	CA.09.13.05.15 CA.X./JU	100	40	25	15	31 g
CA.09.17.1025.X	CA.09.13.10.25 CA.X./JU	110		30		46 g
CA.09.17.1535.X	CA.09.13.15.35 CA.X./JU	115		40		57 g
CA.09.17.2045.X	CA.09.13.20.45 CA.X./JU	120		40		69 g



Air Hand Mounting Brackets
Befestigungsplatte
Staffa per Pinza
Bride de Fixage
Estribo para Pinza

	M*	M1		
CA.04.20.06.X	CA.09.14.06 CA.09.14.07	CA.L./ CA.X..	34 g	
CA.04.20.08.X	CA.09.14.09		35 g	
CA.09.18.1014.X	CA.09.14.10 CA.09.14.14	CA.X../ CA.JU..	41 g	
CA.09.18.1719.X	CA.09.14.14 CA.09.14.17		50 g	
CA.09.18.2225.X	CA.09.14.22 CA.09.14.25		52 g	
CA.09.18.35.JU	CA.09.14.35		78 g	
CA.09.18.4555.JU	CA.09.14.45			102 g
	CA.09.14.55			

Firestone

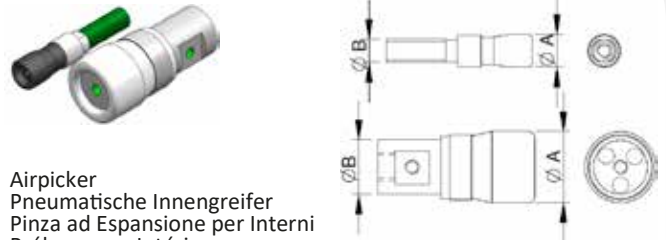

Airpikker
Pneumatische Innengreifer
Pinza ad Espansione per Interni
Préhenseurs Intérieurs
Pinza de Expansión

	FIRESTONE		Working range	A	B	
CA.09.14.06	WP1-M58-0001	N	8.5-10 mm	8	M6	8 g
CA.09.14.07	WP1-M58-0002		10-12 mm	9.5		12 g
CA.09.14.09	WP1-M58-0003		12-17 mm	11	M8X1.25	17 g
CA.09.14.10	WP1-M58-0004		16-21 mm	14	Ø10	28 g
CA.09.14.14 CA.09.14.14.S	WP1-M58-0005 WP1-M58-0024	N S	21-27 mm	19	Ø14	60 g
CA.09.14.17 CA.09.14.17.S	WP1-M58-0006 WP1-M58-0025	N S	24-32 mm	22	Ø17	85 g
CA.09.14.19 CA.09.14.19.S	WP1-M58-0007 WP1-M58-0018	N S	28-36 mm	25	Ø19	105 g
CA.09.14.22 CA.09.14.22.S	WP1-M58-0008 WP1-M58-0026	N S	30-44 mm	27	Ø22	160 g
CA.09.14.25 CA.09.14.25.S	WP1-M58-0009 WP1-M58-0019	N S	32-52 mm	29	Ø25	245 g
CA.09.14.35 CA.09.14.35.S	WP1-M58-0011 WP1-M58-0028	N S	45-65 mm	41	Ø34	180 g
CA.09.14.45	WP1-M58-0012	N	58-85 mm	51	Ø44	370 g
CA.09.14.55	WP1-M58-0013		70-105 mm	63	Ø54	610 g

S = silicone N = neoprene



Protective Sleeve
Greiferschutz
Guaina Protettiva per Pinza
Manche de Protection
Funda Protettiva para Pinza

	FIRESTONE	A	B	M*		
CA.09.15.001	WP1-358-1500	18	38	CA.09.14.14	1 g	
CA.09.15.002	WP1-358-1501	20		CA.09.14.17		
CA.09.15.003	WP1-358-1502	23	CA.09.14.19			
CA.09.15.004	WP1-358-1503	25	44	CA.09.14.22		
CA.09.15.005	WP1-358-1504	27	54	CA.09.14.25		
CA.09.15.006	WP1-358-1505		64	CA.09.14.35		
CA.09.15.007	WP1-358-1506	37	73	CA.09.14.45		2 g
CA.09.15.008	WP1-358-1507	47	79	CA.09.14.55		

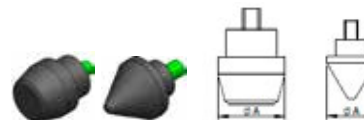

Nose Cones
Führungskonus
Punta Conica per Pinza
Douille de Centrage
Perno de Centrado

	FIRESTONE	A	M*	
CA.09.16.001	WP1-358-1006	14.7	CA.09.14.10	3 g
CA.09.16.002	WP1-358-1016	19.8	CA.09.14.14	5 g
CA.09.16.003	WP1-358-1017	22.9	CA.09.14.17	6 g
CA.09.16.004	WP1-358-1018	27.9	CA.09.14.19	
CA.09.16.005	WP1-358-1019	28.7	CA.09.14.22	7 g
CA.09.16.006	WP1-358-1020	29.7	CA.09.14.25	8 g
CA.09.16.007	WP1-358-1021	42.7	CA.09.14.35	10 g
CA.09.16.008	WP1-358-1022	51.6	CA.09.14.45	12 g
CA.09.16.009	WP1-358-1023	63.8	CA.09.14.55	14 g

AGP

Centering locking unit
 Kopplungsgreifer
 Pinza per aggancio e centraggi
 Doigt de centrage et de serrage
 Pinza de bloqueo y centrado

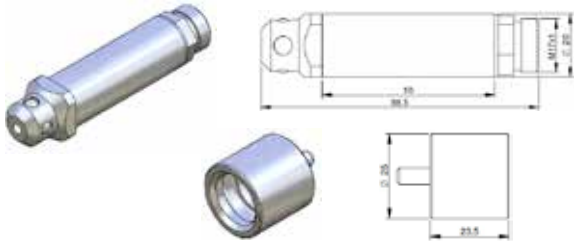

CA.AGP.20.G	Gripper side	93 g
CA.AGP.20.M	Mould side	60 g

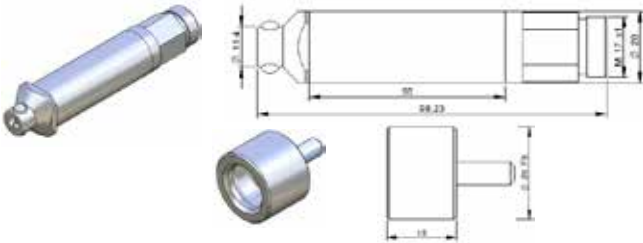

CA.AGP.20.G.20	Gripper side	66 g
CA.AGP.20.M.20	Mould side	30 g



New

PATENT PENDING*

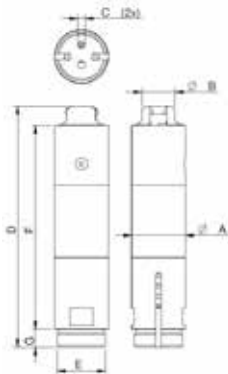

CA.AGP.20.G.GM	Gripper side	116 g
CA.AGP.30.G.GM		377 g



New

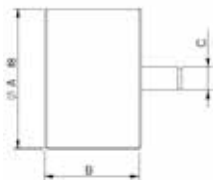

CA.AGP.20.M.GM	Mould side	26 g
CA.AGP.30.M.GM		76 g

Notes

*102019000010569

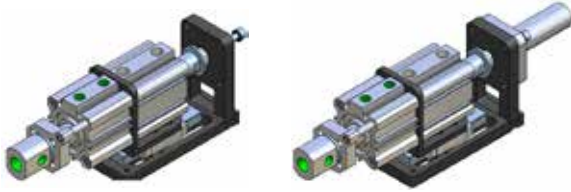

Movable Vacuum Unit BVAE32 with Double Stroke Guided
 Bewegliche Vakuumeinheit BVAE32 mit Doppelhub Geführt
 Slitta Doppia Corsa per Ventosa
 Glissières à Double Course
 Unidad de Doble Carrera para Ventosa

CA.BVAE.322010	988 g
CA.BVAE.32201020	1043 g
CA.BVAE.32201025	1073 g

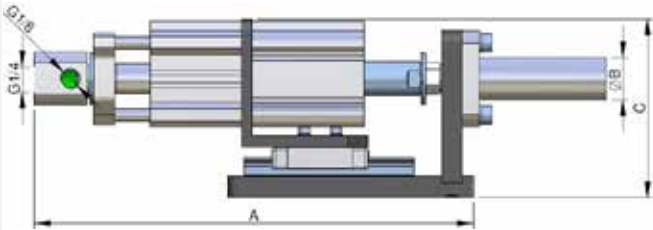

	A	B	C
CA.BVAE.322010	207,5	/	84
CA.BVAE.32201020		∅20	
CA.BVAE.32201025		∅25	

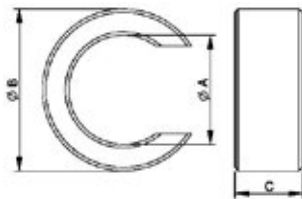

Stroke Reducer
 Distanz-Buchse
 Réducteur de Course
 Anello di Riduzione Corsa
 Casquillo Distanciador

	A	B	C	M*	
CA.DB.05.25	12	20	5	∅25	1 g
CA.DB.10.25			10		2 g
CA.DB.15.25			15		4 g
CA.DB.05.32	16	24	5	∅32	1 g
CA.DB.10.32			10		2 g
CA.DB.15.32			15		3 g



Linear Stroke Unit
 Hubeinheit Linearführung
 Slitta per pinza
 Unité course linéaire
 Unidad linear de carrera

CA.HEH.30.50	1052 g
--------------	--------

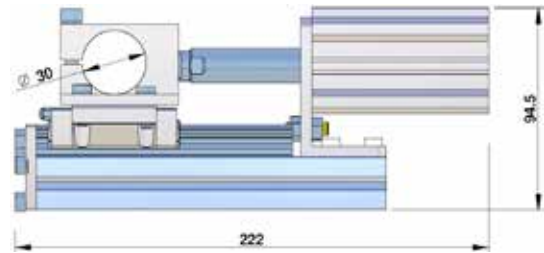

Double Stroke Unit
 Doppelhubeinheit
 Slitta universale con doppia corsa
 Glissières à double course
 Unidad de doble carrera

CA.UDHE.32102020	1375 g
CA.UDHE.32203020	1455 g

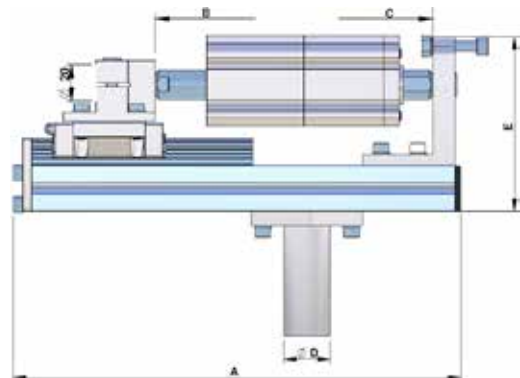

	A	B	C	D	E
CA.UDHE.32102020	243	20	10	∅25	96
CA.UDHE.32203020	283	30	20		

New

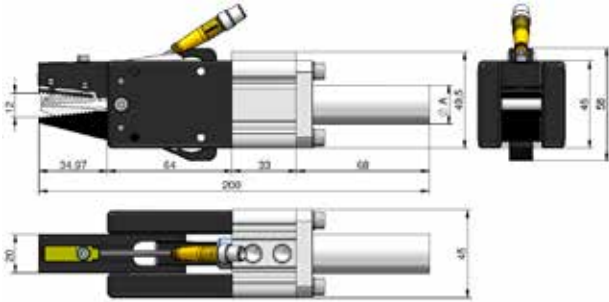

	Closing force (6bar)	
CA.GZ.32.S	350 N	226 g
CA.GZ.3220.S		281 g



CA.GZ.32.FING.S

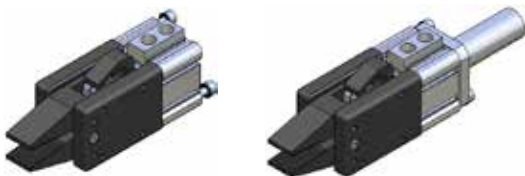

Gripper High Grip Force
Greifzange Extrem Große Schließkraft
Pinza ad Alta Forza di Presa
Pince avec Grand Force de Préhension
Pinza con Alta Fuerza de Agarre

	Closing force (6bar)	
CA.GZ.32	350 N	509 g
CA.GZ.3220		563 g
CA.GZ.3225		591 g

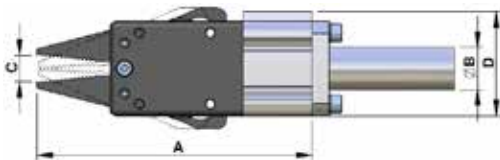

	A	B	C	D
CA.GZ.32	132	/	12,7	49,5
CA.GZ.3220		∅20		
CA.GZ.3225		∅25		

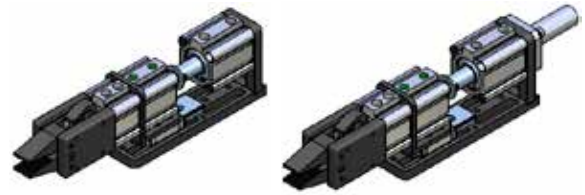

Gripper High Grip Force With Double Stroke
Greifzange Extrem große Schließkraft auf Doppel Hub
Slitta Doppia Corsa con Pinza
Pince avec Grand Force de Préhension et Double Course
Pinza con Alta Fuerza de Agarre y doble Carrera

	Closing force (6bar)	
CA.GZ.322010	350 N	1400 g
CA.GZ.32201020		1455 g
CA.GZ.32201025		1485 g

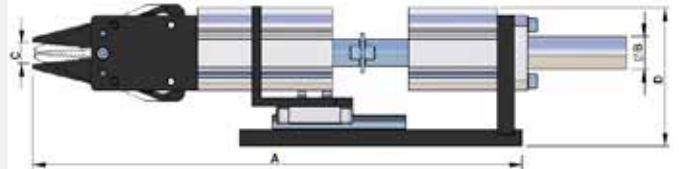

	A	B	C	D
CA.GZ.322010	294	/	12,7	85
CA.GZ.32201020		∅20		
CA.GZ.32201025		∅25		

PAA

Needle gripper
Nadelgreifer
Pinza ad aghi
Pince à aiguilles
Pinza de agujas

CA.PAA.AP	135 g
CA.PAA.AP.D	

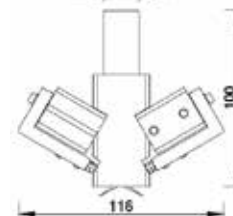
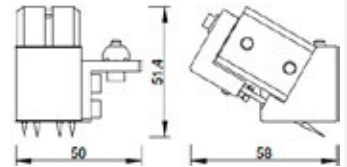
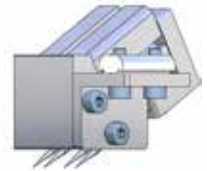

CA.PAA.CF	320 g
CA.PAA.CF.D	

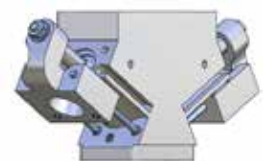

CA.PAA.SP	132 g
-----------	-------

