

**PNEUMATIC COUPLINGS**  
PNEUMATISCHE KUPPLUNGEN

**SERIE 034**

SUPER FLOW **SUPERDURCHFLUSS**



**Couplers and Plugs**  
Kupplungen und Nippel

Connection Anschlüsse | Order No Bestellnr. | SW | L | ØD

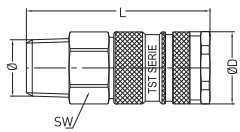

Male Threaded Coupling  
Kupplung mit Aussengewinde

BSPT 1/4"	034 RG 13	24	70	28
BSPT 3/8"	034 RG 17	24	70	28
BSPT 1/2"	034 RG 21	24	72	28
BSPT 3/4"	034 RG 26	27	72	28

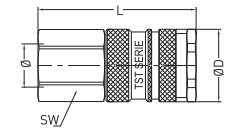

Female Thread Coupling  
Kupplung mit Innengewinde

BSP 1/4"	034 DG 13	24	65	28
BSP 3/8"	034 DG 17	24	65	28
BSP 1/2"	034 DG 21	24	65	28
BSP 3/4"	034 DG 26	30	66	28

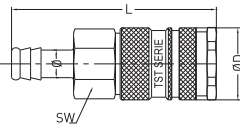

Standard Hose Barb Coupling  
Kupplung mit Schlauchtülle

6 mm - 1/4"	034 HG 06	24	83	28
8 mm - 5/16"	034 HG 08	24	83	28
10 mm - 3/8"	034 HG 10	24	83	28
13 mm - 1/2"	034 HG 13	24	83	28
16 mm - 5/8"	034 HG 16	24	83	28
19 mm - 3/4"	034 HG 19	24	83	28

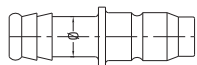

Standard Hose Barb Plug  
Nippel mit Schlauchtülle

6 mm - 1/4"	034 HU 06		53	
10 mm - 3/8"	034 HU 10		53	
13 mm - 1/2"	034 HU 13		53	
16 mm - 5/8"	034 HU 16		53	

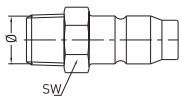

Male Thread Plug  
Nippel mit Aussengewinde

BSPT 3/8"	034 RU 17	19	48	
BSPT 1/2"	034 RU 21	22	52	

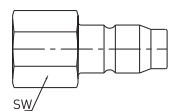

Female Thread Plug  
Nippel mit Innengewinde

BSPT 3/8"	034 DU 17	19	40	
BSPT 1/2"	034 DU 21	24	40	

**Interchangeability - Kompatibilität**  
ATLAS COPCO QIC 15, RECTUS 34

**Temperature Range - Temperaturbereich**  
-20 °C +100 °C (-4 °F +212 °F)

**Working Pressure - Betriebsdruck**  
0 - 35 bar (0 - 508 PSI)

**Flow capacity - Nennweite**  
NW - 6

**Options - Optionen**

- F - Straight through flow - ungehinderter Durchfluss
- S - Stainless Steel - Edelstahl
- V - Viton Seal - Viton Dichtung

For optional orders please add the symbol of your option end of the order no.

Bei Optionsbestellungen Kennbuchstabe bitte hinzufügen (Beispiel: 034 RG 13-K-V)

**Material - Material**

**Coupler Body - Kupplungsgrundkörper:** Brass Nickel Plated - Messing vernickelt

**Sleeve - Hülse:** Steel Nickel Plated - Stahl vernickelt

**Valve - Ventil:** Zinc Diecasting

**Springs - Federn:** Stainless Steel - Edelstahl

**Locking O-Ring - Sprengring:** Stainless Steel - Edelstahl

**Balls - Kugeln:** Edelstahl AISI 420

**Seals - Dichtungen:** Nitrile (Ni) - NBR (Ni)

**Plug - Nippel:** Steel Nickel Plated - Stahl vernickelt

